

SWEET CHERRY PIE

Anna and Tony Newman have combined striking red contemporary cabinetry with statement flooring to stunning effect in their kitchen



“The open-plan design is fundamental to our lifestyle as we love cooking and entertaining, and now the four of us can be together in the kitchen. The bright red hi-gloss finish is bold and gives the strong, modern look we wanted to achieve.

I couldn't ask for more”

ANNA NEWMAN

DalUni rubber flooring in Geranium and Gris Chaillot from Dalsouple has been laid in a geometric pattern around the island to create an eye-catching feature. The Newmans chose luscious red hi-gloss units for their dazzling new scheme, keeping the walls fresh with Kelly Hoppen's pale Cotton paint



DESIGN & CABINERY

- Jem Foster at **Re-Nu Kitchens**, Giebelands, Crowcombe, Taunton, Somerset TA4 4AE (01984 618499) www.re-nukitchens.co.uk
- Red hi-gloss, vinyl-wrapped cabinetry from the Bella Modena range by BA Components

WORKTOPS

- 19mm back-painted toughened glass, 100% Glass. Price per sq m, including cutting and fitting **£800**

SINK & TAP

- SK75 Stark undermounted single-bowl sink in brushed steel, Luisina at Sterling Distribution **£356**
- TGSNKC Target single-lever mixer tap with pull-out rinse in chrome, Bristan **£200**

APPLIANCES (shown)

- Built-in double oven, for similar try ZOD685X, Zanussi **£622**
- Built-in microwave, for similar try AMW420, Whirlpool **£289**
- Built-in coffee machine, for similar try ZCOF637X, Zanussi **£519**
- American-style fridge freezer, for similar try RSH1FBRS, Samsung **£940**
- BWE40 freestanding wine cooler, Baumatic **£258**

APPLIANCES (not shown)

- Four-zone ceramic hob, Baumatic **£412**
- 2 x fully integrated slimline dishwashers, Electrolux, each **£380**

For stockists, see page 152

There was no agonising house hunting when Anna Newman and her husband Tony decided to leave London to return to Anna's native Somerset and the rural barn conversion she grew up in. The house had become impractical for Anna's mother, so the couple took it on as their new home, with their children, Phoebe, 15, and Josh, nine, and built Anna's mother a new house next door.

TV script supervisor Anna and Tony, who works in antique restoration, started a gradual refurbishment of the property with the kitchen being a key area to change. 'The room itself was a bit worn and there was a separate snug next door, so the layout didn't really suit family life,' explains Anna. 'I love entertaining and we visualised a big, open space where everyone could congregate together.'

The wall between the two rooms came down and French windows replaced some of the old glass panels, creating a generous, light-filled area with access to the garden. While the building work was in progress, Anna and Tony began planning the new kitchen. 'We wanted something very modern and streamlined that didn't look too "fitted",' recalls Anna. 'I'd set my heart on a big, American-style fridge freezer and I wanted space for pictures and decorative pieces as well.'

Anna checked out all the various high street options before settling on striking cherry red units from Jem Foster of local firm Re-Nu Kitchens. 'Jem had fitted my sister-in-law's kitchen,' she

reveals. 'We wanted to keep within a reasonable budget and we were very impressed with his workmanship and the value he offered. He's a former woodwork teacher and very meticulous.'

Anna's job often takes her to London, where she browsed the shops for inspiration. On one of her trips she spotted a glass worksurface and was immediately smitten. 'I just had to have it,' she laughs. 'We'd already dismissed wood and granite because we felt they wouldn't suit the red units.'

Walking around other kitchen showrooms also prompted the couple to choose a functional central island that would house the sink, hob and bins, with storage largely concentrated around the walls. However, working out the exact locations for the various elements proved quite a challenge. 'We had sheets of MDF and cardboard boxes to represent the island and the appliances and we spent hours moving them about,' says Anna.

Devoting a substantial amount of time to research and planning their kitchen now means that the Newmans' design includes some well thought out features. Anna opted for a sizeable sink for soaking large pans, a smart compost bin for peelings and two dishwashers that run alternately to save dirty crockery lying around.

Enduring several months of upheaval for their new kitchen was just one aspect of an ambitious renovation project and with the disruption now firmly behind them, Anna couldn't be more pleased with the results. **BK**



Anna is delighted with the versatility of her chrome-finished Bristan tap. Activated by a nifty, single-lever joystick fitting, it has a flexible pull-out hose, a spray function and can rotate 180° to reach both sides of the large sink below. The cream salt pig, by Nigella Lawson's Living Kitchen, is from Bliss Home

Anna and Tony picked this stylish rubber flooring for its durability and easy-clean smooth surface. Anna was impressed by the wide range of colours and the option to cut the tiles to create a unique design. The antique breakfast table is covered in a pretty Rose oilcloth from Cath Kidston, which is a great tablecloth for families as its vinyl finish makes it easy to wipe down after meals



FAVOURITE DESIGN ELEMENT: 'The little bin integrated into the worktop. When I prepare vegetables, I want somewhere I can quickly tip the rubbish in to rather than crossing the room with peelings'



It took Anna some time to track down a fridge freezer with an energy-saving 'refreshment bar', a feature that was recommended to her by a friend. This function means that the main door can stay shut if the children are getting a drink. Anna chose a model that also has a roomy freezer and dispenses ice and chilled water

The concealed worktop bin came from Franke and was sourced by designer Jem after Anna saw the idea in a magazine. Its stainless-steel lid and rubber seal are easily cleaned in the dishwasher. The glass worktop itself is back-painted in Pugin Red by Dulux



A double oven, microwave and coffee maker are built in together in a practical, easy-access stack on one side of the room. The various options offer both conventional and fan-assisted cooking as well as grilling and defrosting. Roomy cupboards above offer Anna extra storage for oven trays and roasting dishes. The striped crockery is by Price & Kensington

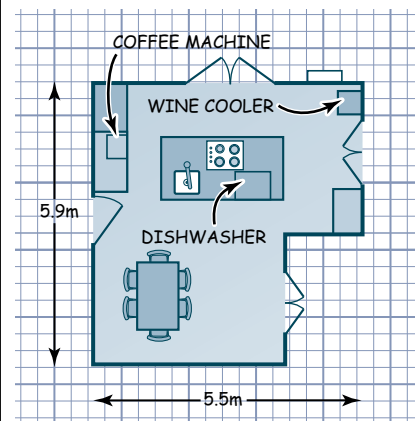

GUIDE PRICE

- Cabinetry only **£5,300**